

FOR LEASE

1800 FRUITVILLE PIKE
CLASS "A" OFFICE SPACE
 Total GLA: 42,000 SF

LANCASTER, PA 17601
 MANHEIM TOWNSHIP
 LANCASTER COUNTY

FRUITVILLE PIKE & RT. 30

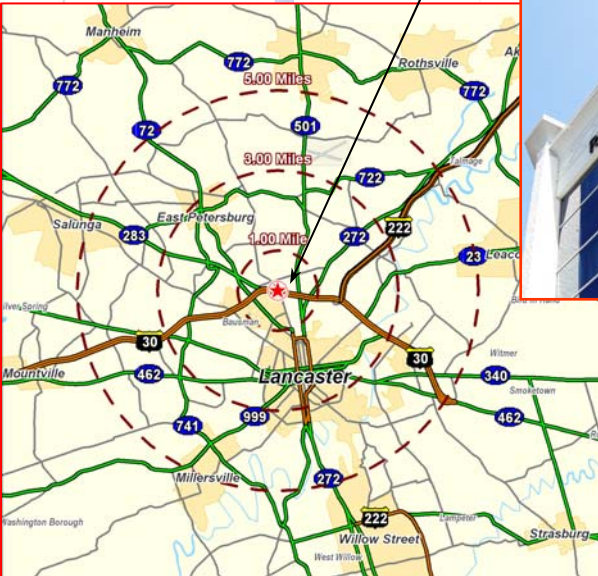

SPACE AVAILABLE:

- +/- 5,700 Square Feet (First Floor)

2008 DEMOGRAPHICS:

	<u>1 Mile</u>	<u>3 Mile</u>	<u>5 Mile</u>
Population	3,203	93,115	156,739
Avg. HH Income:	\$77,892	\$62,061	\$66,370

Traffic Count for Rt. 30 & Fruitville Pike: 74,000 vehicles daily

Reinsel Kuntz Leshor's building is located at Fruitville Pike & Route 30, it's a newly constructed Class "A" office building, that was built on vacant ground which sits at the major "crossroads" of Lancaster County, known as Route 30 & Route 283.

The building has 10,500 square feet per floor with a total of four (4) floors with 188 parking spaces.

Zoned B-4



*See reverse side for *site plan*

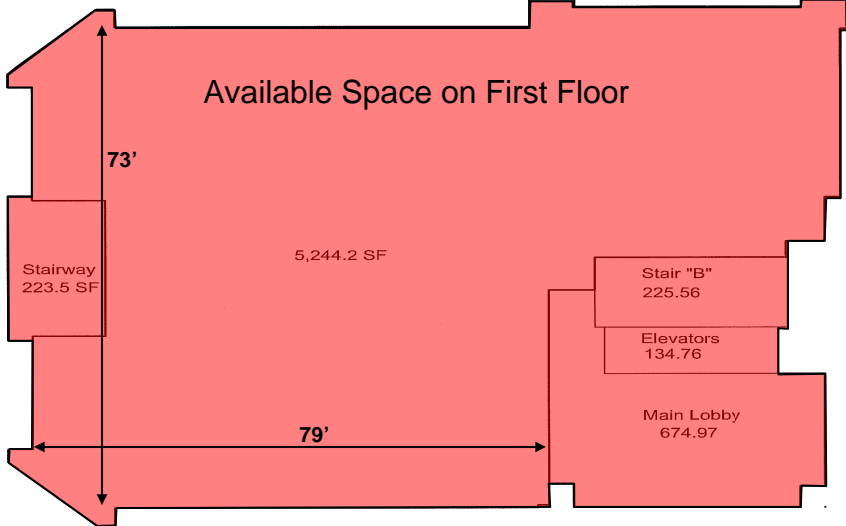

Subject to Change

1 st Floor	Available	5,700sf
1 st Floor	Graystone Bank	4,540sf
2 nd Floor	Reinsel, Kuntz, Lesh	3,642sf
2 nd Floor	Reinsel, Kuntz, Lesh	6,858sf
3 rd Floor	Reinsel, Kuntz, Lesh	10,500sf
4 th Floor	Reinsel, Kuntz, Lesh	10,500sf

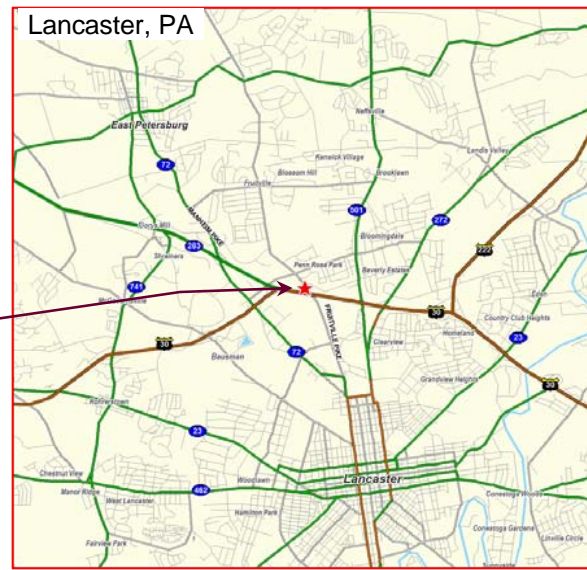

Leasing Site Plan
 Fruitville Pike & Route 30
 Reinsel Kuntz Lesh
 Lancaster, PA 17601
 (North Side of Lancaster, PA)

For additional information please contact:

LMS Commercial Real Estate
 LEASING • MANAGEMENT • SALES

120 North Pointe Blvd. • Suite 301 • Lancaster, PA 17601 • phone 717-569-9373 • fax 717-560-9909 • www.lms-pma.com